

# RTD High Temp MgO Elements

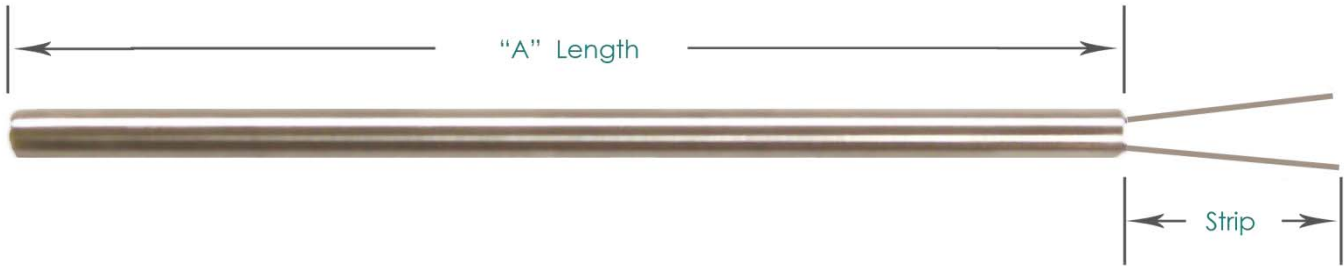

	1	2	3	4		5	6	7	8	9		10
R	A			H	-	W				-		

### (1) Sheath Termination

Bulk Material, Stripped Bare Lead	A
-----------------------------------	---

### (2) Element Type

Resistance at 0°C	2 Wire	3 Wire	4 Wire
Platinum 100Ω Single	A	B	C
Platinum 100Ω Dual	D	E	N/A

### (3) Accuracy & Temperature Coefficient

Accuracy at 0°C		Din .00385	Jis .00392
Class B	0.12%	G	H
Class A	0.06%	J	K
1/3 <sup>rd</sup>	0.04%	M	N

Consult factory for other element accuracies.

### (4) Temperature Range

"H" Series -200°C to 500°C (-328°F to 932°F )	H
--	---

### (5) Sheath Diameter (inches)

1/8 (.125)	G	1/4 (.250)	K
3/16 (.188)	I	3/8 (.375)	N

### (6) Sheath Material

316 SST	W
---------	---

### (7 & 8) Sheath Length ("A")

Whole Inches: Example 06 = 6 inches
-------------------------------------

### (9) Sheath Fractional Length ("A" Fractional)

None	A	1/4	G	5/8	N
1/16	B	3/8	J	3/4	Q
1/8	C	1/2	L	7/8	S
3/16	E				

### (10) Strip Length

1/4"	A
1/2"	B
3/4"	C
1"	D
2"	E
2-1/2"	F
3"	G

**Note:** The available strip length options may be limited on small diameter & some duplex configurations due to the fragile nature of the conductors.

# RTD Tube & Lead Wire Style

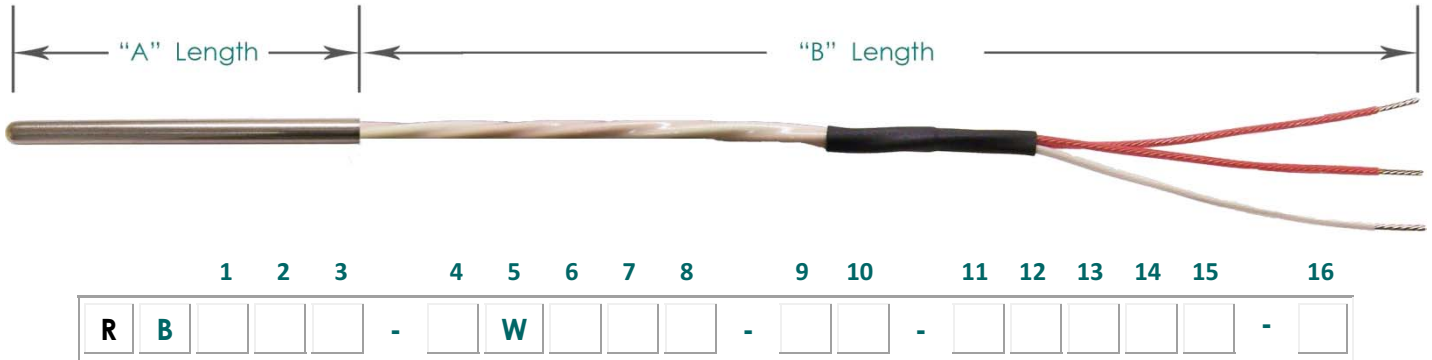

## (1) Element Type

Resistance at 0°C	2 Wire	3 Wire	4 Wire
Platinum 100Ω Single	A	B	C
Platinum 100Ω Dual	D	E	N/A
Platinum 1000Ω Single	K	L	M

Note: 1000Ω not available with "H" Series (Temp Range)

## (2) Accuracy & Temperature Coefficient

Accuracy at 0°C	Din .00385	Jis .00392
Class B ±0.12%	G	H
Class A ±0.06%	J	K
1/3 <sup>rd</sup> ±0.04%	M	N

Consult factory for other element accuracies.

## (3) Temperature Range

"L" Series -50°C to 200°C (-58°F to 392°F)	L
"M" Series -50°C to 400°C (-58°F to 752°F)	M

## (4) Sheath Diameter (inches)

1/8 (.125)	G	1/4 (.250)	K
3/16 (.188)	I	3/8 (.375)	N

## (5) Sheath Material

316 SST	W
---------	---

## (6 & 7) Sheath Length ("A")

Whole Inches: Example 06 = 6 inches
-------------------------------------

## (8) Sheath Fractional Length ("A" Fractional)

None	A	1/4	G	5/8	N
1/16	B	3/8	J	3/4	Q
1/8	C	1/2	L	7/8	S
3/16	E				

## (9 & 10) Sheath Mounting Fitting

Select fitting from pages M-19 & M-20	
None	00

## (11) Lead Wire Type

Stranded Wire	°C	°F	Code
Fiberglass Insulated Cable	450°C	842°F	D
Fiberglass w/ SST Flex Armor	450°C	842°F	E
Fiberglass w/ SST Over Braid	450°C	842°F	F
Teflon Insulated Cable	200°C	392°F	M
Teflon Cable w/ SST Flex Armor	200°C	392°F	N
Teflon Cable w/ SST Over Braid	200°C	392°F	O
Shielded Teflon Cable	200°C	392°F	P
Individual Teflon Single Leads	200°C	392°F	1
Individual Fiberglass Single Leads	450°C	842°F	9

Note: For a complete list of all wire options, refer to page ??

## (12, 13, & 14) Lead Wire Length Inches ("B")

Whole Inches: Example: 048 = 48 inches

Note: For lead wire beyond the flex armor ("C" length), include length after "B" length. Example: 048(012) = 12" of leads beyond the flex

## (15) Lead Wire Termination Options

None	A
Split Leads (2-1/2") / Stripped	B
Split Leads with #8 Spade Lugs	C
Split Leads with 1/4" Push-On Terminals	E
Split Leads with Insulated Wire Sleeves	J
Standard Male Plug (200°C / 382°F)	K
Standard Plug with Mating Jack	L
Standard Female Jack	M
Miniature Male Plug (200°C / 382°F)	Q
Miniature Plug with Mating Jack	R
Miniature Female Jack	S

## (16) Special Options

BX Electrical Connector, 1/2"	NA	NA	F
PVC Coating over Flex Armor (Black)	90°C	194°F	J
Teflon Coating over Flex Armor (White)	200°C	392°F	K
Teflon Encapsulated Sheath (Black)	200°C	392°F	T

\*For a complete list of Special Options, refer to page ??

# RTD Transition Lead Wire Style

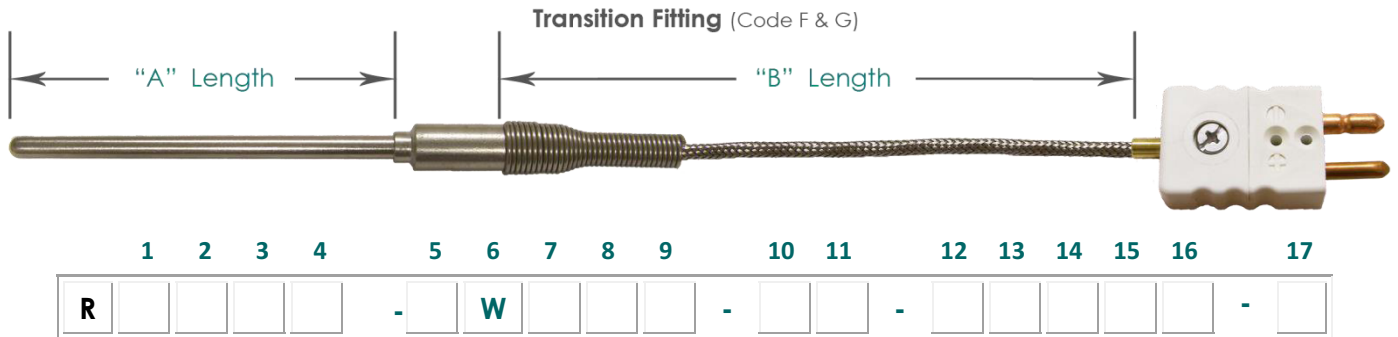

## (1) Transition Style

Style	°C	°F	Code
Standard Transition Fitting	200°C	392°F	D
Hi-Temp Transition Fitting	450°C	842°F	E
Transition w/ Relief Spring	200°C	392°F	F
Hi Temp w/ Relief Spring	450°C	842°F	G

## (2) Element Type

Resistance at 0°C	2 Wire	3 Wire	4 Wire
Platinum 100Ω Single	A	B	C
Platinum 100Ω Dual	D	E	N/A
Platinum 1000Ω Single	K	L	M

Note: 1000Ω not available with "H" Series (Temp Range)

## (3) Accuracy & Temperature Coefficient

Accuracy at 0°C		Din .00385	Jis .00392
Class B	±0.12%	G	H
Class A	±0.06%	J	K
1/3 <sup>rd</sup>	±0.04%	M	N

Consult factory for other element accuracies.

## (4) Temperature Range

"L" Series -50°C to 200°C (-58°F to 392°F)	L
"M" Series -50°C to 400°C (-58°F to 752°F)	M
"H" Series -200°C to 500°C (-328°F to 932°F)	H

## (5) Sheath Diameter (inches)

1/8 (.125)	G	1/4 (.250)	K
3/16 (.188)	I	3/8 (.375)	N

## (6) Sheath Material

316 SST	W
---------	---

## (7 & 8) Sheath Length ("A")

Whole Inches: Example 06 = 6 inches
-------------------------------------

## (9) Sheath Fractional Length ("A" Fractional)

None	A	1/8	C	1/4	G	1/2	L	3/4	Q
1/16	B	3/16	E	3/8	J	5/8	N	7/8	S

## (10 & 11) Sheath Mounting Fitting

Select fitting from pages M-19 & M-20	
None	00

## (12) Lead Wire Type

Stranded Wire	°C	°F	Code
Fiberglass Insulated Cable	450°C	842°F	D
Fiberglass w/ SST Flex Armor	450°C	842°F	E
Fiberglass w/ SST Over Braid	450°C	842°F	F
Teflon Insulated Cable	200°C	392°F	M
Teflon Cable w/ SST Flex Armor	200°C	392°F	N
Teflon Cable w/ SST Over Braid	200°C	392°F	O
Shielded Teflon Cable	200°C	392°F	P
Individual Teflon Single Leads	200°C	392°F	1
Individual Fiberglass Single Leads	450°C	842°F	9

Note: For a complete list of all wire options, refer to page ??

## (13, 14, & 15) Lead Wire Length Inches ("B")

Whole Inches: Example: 048 = 48 inches
--

Note: For lead wire beyond the flex armor ("C" length), include length After "B" length. Example: 048(012) = 12" of leads beyond the flex

## (16) Lead Wire Termination Options

None	A
Split Leads (2-1/2") / Stripped	B
Split Leads with #8 Spade Lugs	C
Split Leads with 1/4" Push-On Terminals	E
Split Leads with Insulated Wire Sleeves	J
Standard Male Plug (200°C / 382°F)	K
Standard Plug with Mating Jack	L
Standard Female Jack	M
Miniature Male Plug (200°C / 382°F)	Q
Miniature Plug with Mating Jack	R
Miniature Female Jack	S

## (17) Special Options

BX Electrical Connector, 1/2"	NA	NA	F
PVC Coating over Flex Armor (Black)	90°C	194°F	J
Teflon Coating over Flex Armor (White)	200°C	392°F	K
Teflon Encapsulated Sheath (Black)	200°C	392°F	T

\*For a complete list of Special Options, refer to page ??

# RTD Standard Connectors



	1	2	3	4		5	6	7	8	9		10	11		12
R					-		W				-			-	

### (1) Sheath Termination

Connector Option	°C	°F	Code
Standard Male Plug	200°C	392°F	K
Standard Plug with Mating Jack	200°C	392°F	L
Standard Female Jack	200°C	392°F	M

### (2) Element Type

Resistance at 0°C	2 Wire	3 Wire	4 Wire
Platinum 100Ω Single	A	B	C
Platinum 100Ω Dual	D	E	N/A
Platinum 1000Ω Single	K	L	M

Note: 1000Ω not available with "H" Series (Temp Range)

### (3) Accuracy & Temperature Coefficient

Accuracy at 0°C		Din .00385	Jis .00392
Class B	±0.12%	G	H
Class A	±0.06%	J	K
1/3 <sup>rd</sup>	±0.04%	M	N

Consult factory for other element accuracies.

### (4) Temperature Range

"L" Series -50°C to 200°C (-58°F to 392°F)	L
"M" Series -50°C to 400°C (-58°F to 752°F)	M
"H" Series -200°C to 500°C (-328°F to 932°F)	H

### (5) Sheath Diameter (inches)

1/8 (.125)	G	1/4 (.250)	K
3/16 (.188)	I	3/8 (.375)	N

### (6) Sheath Material

316 SST	W
---------	---

### (7 & 8) Sheath Length ("A")

Whole Inches: Example 06 = 6 inches
-------------------------------------

### (9) Sheath Fractional Length ("A" Fractional)

None	A	1/4	G	5/8	N
1/16	B	3/8	J	3/4	Q
1/8	C	1/2	L	7/8	S
3/16	E				

### (10 & 11) Sheath Mounting Fitting

NPT Size →	1/8"	1/4"	1/2"
SST Compression Fitting	1A	1B	1D
Brass Compression Fitting	2A	2B	2D
Re-Adjustable SST Compr. Ftg.	3A	3B	3D

Note: For a complete listing of sensor mounting options, compatibility, specifications, and ordering instructions, please see page M-7.

### (12) Special Options

Compression Tube Adapter on Connector	C
Teflon Encapsulated Sheath (Black)	T

# RTD Miniature Connectors

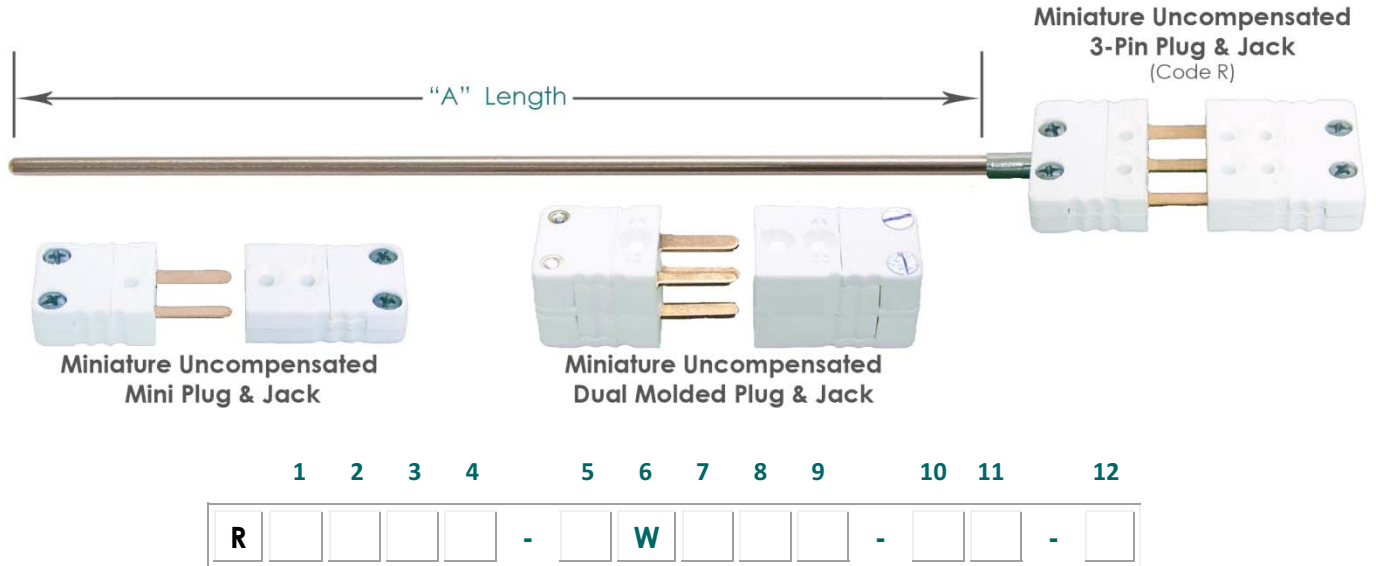

## (1) Sheath Termination

Connector Option	°C	°F	Code
Miniature Male Plug	200°C	392°F	Q
Miniature Plug with Mating Jack	200°C	392°F	R
Miniature Female Jack	200°C	392°F	S

## (2) Element Type

Resistance at 0°C	2 Wire	3 Wire	4 Wire
Platinum 100Ω Single	A	B	C
Platinum 100Ω Dual	D	E	N/A
Platinum 1000Ω Single	K	L	M

Note: 1000Ω not available with "H" Series (Temp Range)

## (3) Accuracy & Temperature Coefficient

Accuracy at 0°C	Din .00385	Jis .00392
Class B ±0.12%	G	H
Class A ±0.06%	J	K
1/3 <sup>rd</sup> ±0.04%	M	N

Consult factory for other element accuracies.

## (4) Temperature Range

"L" Series -50°C to 200°C (-58°F to 392°F)	L
"M" Series -50°C to 400°C (-58°F to 752°F)	M
"H" Series -200°C to 500°C (-328°F to 932°F)	H

## (5) Sheath Diameter (inches)

1/8 (.125)	G	3/16 (.188)	I
------------	---	-------------	---

## (6) Sheath Material

316 SST	W
---------	---

## (7 & 8) Sheath Length ("A")

Whole Inches: Example 06 = 6 inches
-------------------------------------

## (9) Sheath Fractional Length ("A" Fractional)

None	A	1/4	G	5/8	N
1/16	B	3/8	J	3/4	Q
1/8	C	1/2	L	7/8	S
3/16	E				

## (10 & 11) Sheath Mounting Fitting

NPT Size →	1/8"	1/4"	1/2"
SST Compression Fitting	1A	1B	1D
Brass Compression Fitting	2A	2B	2D
Re-Adjustable SST Compr. Ftg.	3A	3B	3D

Note: For a complete listing of sensor mounting options, compatibility, specifications, and ordering instructions, please see page M-?.

## (12) Special Options

Compression Tube Adapter on Connector	C
Teflon Encapsulated Sheath 200°C / 392°F (Black)	T

# RTD Flip-Top Connection Heads

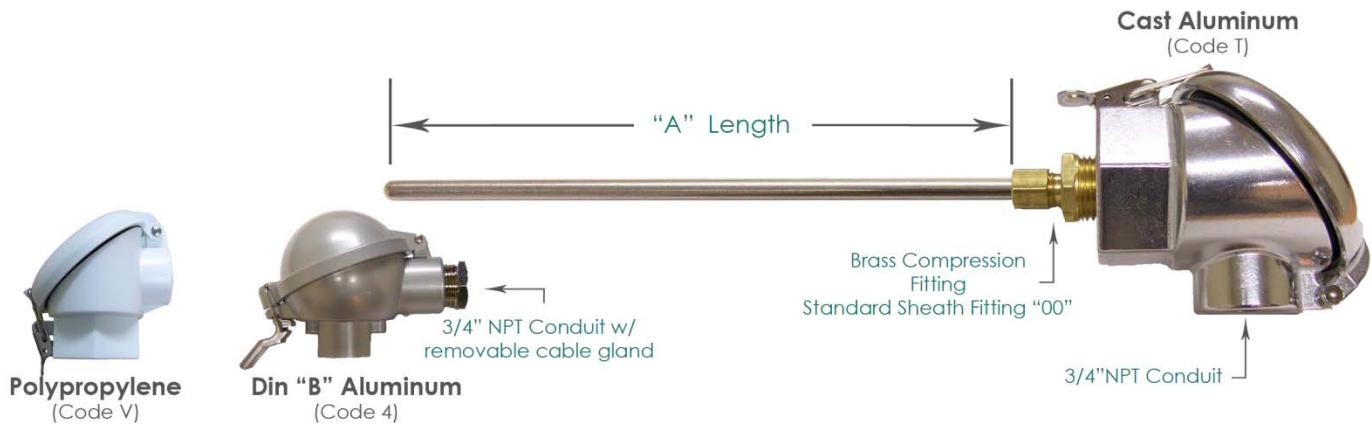

	1	2	3	4		5	6	7	8	9		10	11		12
R					-		W				-			-	

### (1) Sheath Termination

Material	°C	°F	Code
Cast Aluminum	200°C	392°F	T
White Polypropylene	90°C	194°F	V
Din "B" Size Aluminum WP	200°C	392°F	4

### (2) Element Type

Resistance at 0°C	2 Wire	3 Wire	4 Wire
Platinum 100Ω Single	A	B	C
Platinum 100Ω Dual	D	E	N/A
Platinum 1000Ω Single	K	L	M

Note: 1000Ω not available with "H" Series (Temp Range)

### (3) Accuracy & Temperature Coefficient

Accuracy at 0°C		Din .00385	Jis .00392
Class B	±0.12%	G	H
Class A	±0.06%	J	K
1/3 <sup>rd</sup>	±0.04%	M	N

Consult factory for other element accuracies.

### (4) Temperature Range

"L" Series -50°C to 200°C (-58°F to 392°F)	L
"M" Series -50°C to 400°C (-58°F to 752°F)	M
"H" Series -200°C to 500°C (-328°F to 932°F )	H

### (5) Sheath Diameter (inches)

1/8 (.125)	G	1/4 (.250)	K
3/16 (.188)	I	3/8 (.375)	N

### (6) Sheath Material

316 SST	W
---------	---

### (7 & 8) Sheath Length ("A")

Whole Inches: Example 06 = 6 inches
-------------------------------------

### (9) Sheath Fractional Length ("A" Fractional)

None	A	1/4	G	5/8	N
1/16	B	3/8	J	3/4	Q
1/8	C	1/2	L	7/8	S
3/16	E				

### (10 & 11) Sheath Mounting Fitting

NPT Size →	1/8"	1/4"	1/2"
SST Compression Fitting	1A	1B	1D
Brass Compression Fitting	2A	2B	2D
Re-Adjustable SST Compr. Ftg.	3A	3B	3D
Fixed Hex Nipple, 316 SST	46	47	48
Spring Loaded Hex Nipple SST	N/A	N/A	56

Note: For a complete listing of sensor mounting options, compatibility, specifications, and ordering instructions, please see page M-?.

### (12) Special Options

Non-Isolated Transmitter, PC Programmable	Q9
Isolated Transmitter, PC Programmable	Q2
Grounding Stud (Screw)	G
Conduit Opening Reducer, 3/4" x 1/2"	R
Teflon Encapsulated Sheath 200°C / 392°F (Black)	T

See the Temperature Transmitter Section for complete transmitter options and specifications.

# RTD Screw-Cover Connection Heads

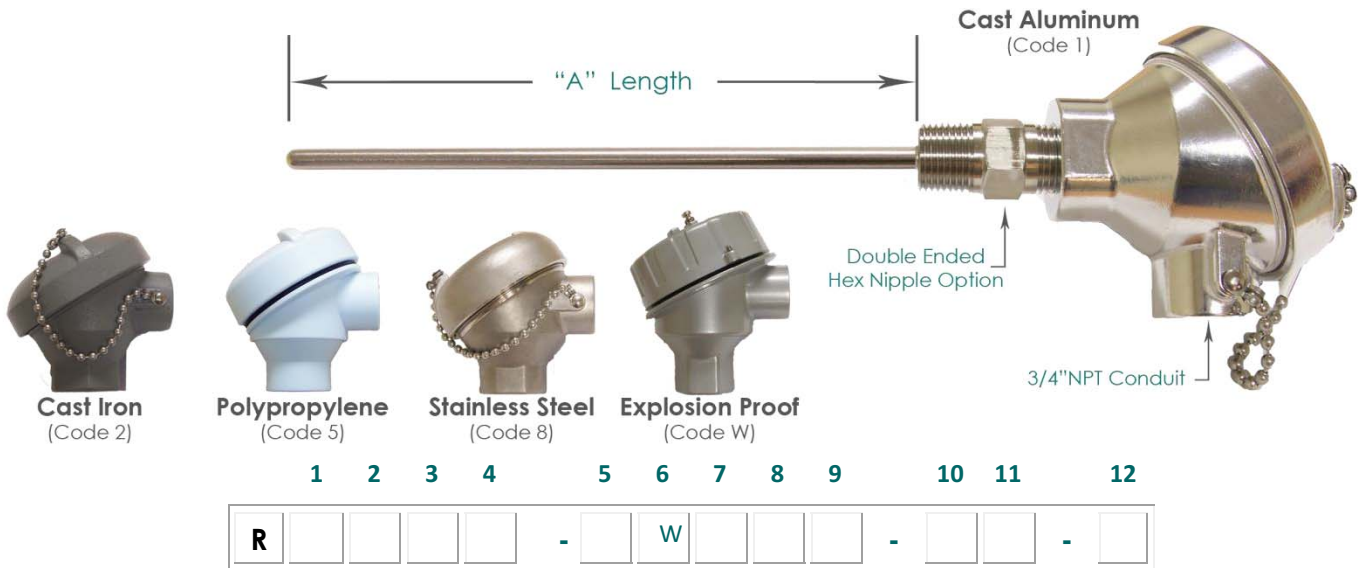

R					-		W									
---	--	--	--	--	---	--	---	--	--	--	--	--	--	--	--	--

## (1) Sheath Termination

Material	°C	°F	Rating	Code
Cast Aluminum	200°C	392°F	NEMA 4	1
Cast Iron	200°C	392°F	NEMA 4	2
White Polypropylene	90°C	194°F	IP65	5
Stainless Steel (316)	200°C	392°F	NEMA4X	8
Explosion Proof *	90°C	194°F	NEMA 4	W

\*FM Approved Class I, DIV I, Groups A,B,C,D, T6  
Class II, III, DIV I, Groups E, F, G, T6

## (2) Element Type

Resistance at 0°C	2 Wire	3 Wire	4 Wire
Platinum 100Ω Single	A	B	C
Platinum 100Ω Dual	D	E	N/A
Platinum 1000Ω Single	K	L	M

Note: 1000Ω not available with "H" Series (Temp Range)

## (3) Accuracy & Temperature Coefficient

Accuracy at 0°C	Din .00385	Jis .00392
Class B ±0.12%	G	H
Class A ±0.06%	J	K
1/3 <sup>rd</sup> ±0.04%	M	N

Consult factory for other element accuracies.

## (4) Temperature Range

"L" Series -50°C to 200°C (-58°F to 392°F)	L
"M" Series -50°C to 400°C (-58°F to 752°F)	M
"H" Series -200°C to 500°C (-328°F to 932°F)	H

## (5) Sheath Diameter (inches)

1/8 (.125)	G	1/4 (.250)	K
3/16 (.188)	I	3/8 (.375)	N

## (6) Sheath Material

316 SST	W
---------	---

## (7 & 8) Sheath Length ("A")

Whole Inches: Example 06 = 6 inches
-------------------------------------

## (9) Sheath Fractional Length ("A" Fractional)

None	A	1/4	G	5/8	N
1/16	B	3/8	J	3/4	Q
1/8	C	1/2	L	7/8	S
3/16	E				

## (10 & 11) Sheath Mounting Fitting

NPT Size →	1/8"	1/4"	1/2"
SST Compression Fitting	1A	1B	1D
Brass Compression Fitting	2A	2B	2D
Re-Adjustable SST Compr. Ftg.	3A	3B	3D
Fixed Hex Nipple, 316 SST	46	47	48
Spring Loaded Hex Nipple SST	N/A	N/A	56

Note: For a complete listing of sensor mounting options, compatibility, specifications, and ordering instructions, please see page M-?.

## (12) Special Options

Non-Isolated Transmitter, PC Programmable	Q9
Isolated Transmitter, PC Programmable	Q2
Grounding Stud (Screw)	G
Conduit Opening Reducer, 3/4" x 1/2"	R
Teflon Encapsulated Sheath 200°C / 392°F (Black)	T

See the Temperature Transmitter Section for complete transmitter options and specifications.

# RTD Miniature Connection Heads

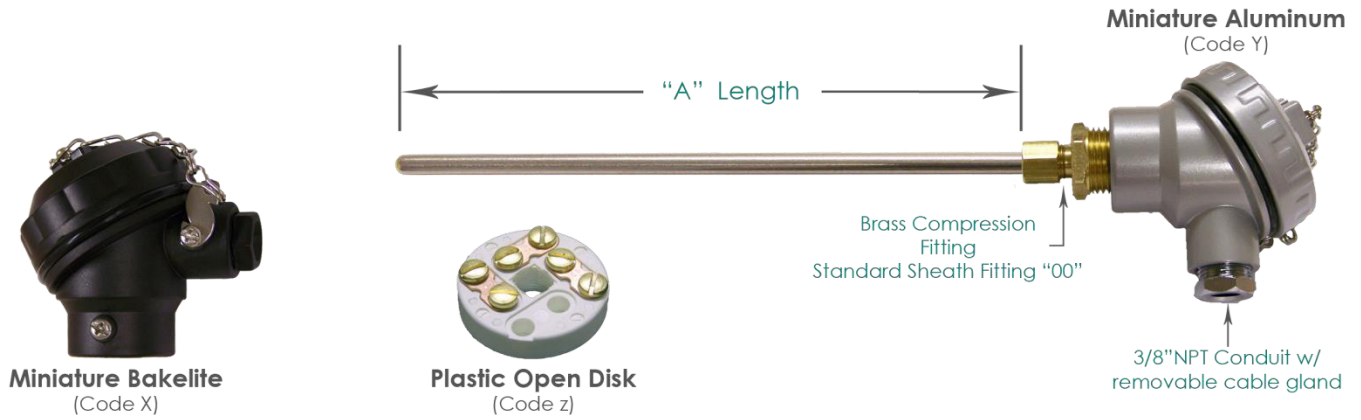

	1	2	3	4		5	6	7	8	9		10	11		12
R					-		W				-			-	

### (1) Sheath Termination

Material	°C	°F	Code
Miniature Aluminum	200°C	392°F	Y
Miniature Bakelite	200°C	392°F	X
Plastic Open Disk	200°C	392°F	Z

### (2) Element Type

Resistance at 0°C	2 Wire	3 Wire	4 Wire
Platinum 100Ω Single	A	B	C
Platinum 100Ω Dual	D	E	N/A
Platinum 1000Ω Single	K	L	M

Note: 1000Ω not available with "H" Series (Temp Range)

### (3) Accuracy & Temperature Coefficient

Accuracy at 0°C		Din .00385	Jis .00392
Class B	±0.12%	G	H
Class A	±0.06%	J	K
1/3 <sup>rd</sup>	±0.04%	M	N

Consult factory for other element accuracies.

### (4) Temperature Range

"L" Series -50°C to 200°C (-58°F to 392°F)	L
"M" Series -50°C to 400°C (-58°F to 752°F)	M
"H" Series -200°C to 500°C (-328°F to 932°F )	H

### (5) Sheath Diameter (inches)

1/8 (.125)	G	1/4 (.250)	K
3/16 (.188)	I	3/8 (.375)	N

### (6) Sheath Material

316 SST	W
---------	---

### (7 & 8) Sheath Length ("A")

Whole Inches: Example 06 = 6 inches
-------------------------------------

### (9) Sheath Fractional Length ("A" Fractional)

None	A	1/4	G	5/8	N
1/16	B	3/8	J	3/4	Q
1/8	C	1/2	L	7/8	S
3/16	E				

### (10 & 11) Sheath Mounting Fitting

NPT Size →	1/8"	1/4"	1/2"
SST Compression Fitting	1A	1B	1D
Brass Compression Fitting	2A	2B	2D
Re-Adjustable SST Compr. Ftg.	3A	3B	3D
Fixed Hex Nipple, 316 SST	46	47	48
Spring Loaded Hex Nipple SST	N/A	N/A	56

Note: For a complete listing of sensor mounting options, compatibility, specifications, and ordering instructions, please see page M-?.

### (12) Special Options

Grounding Stud (Screw)	G
Teflon Encapsulated Sheath 200°C / 392°F (Black)	T



# SHEATH MOUNTING FITTINGS

## Fixed Brazed or Welded Bushings

Code	Description	NPT	"L"
6A	316 Stainless Steel	1/8	.80
6B	316 Stainless Steel	1/4	.81
6D	316 Stainless Steel	1/2	1.09
6E	316 Stainless Steel	3/4	1.20
7A	Brass	1/8	.80
7B	Brass	1/4	.96
7D	Brass	1/2	1.20

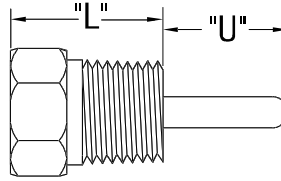

Insert "U" length  
 Ex. 6D04 = 4" "U" length



## COMPRESSION FITTINGS

One-time Adjustable*			Available Sizes and "L" Length				
Code	Description	NPT	1/16"	1/8"	3/16"	1/4"	3/8"
1A	Stainless Steel	1/8	1.27	1.24	1.29	1.29	N/A
1B	Stainless Steel	1/4	1.22	1.40	1.43	1.49	1.57
1D	Stainless Steel	1/2	N/A	1.66	N/A	1.76	1.82
2A	Brass	1/8	1.03	1.02	1.10	1.15	N/A
2B	Brass	1/4	1.22	1.40	1.18	1.24	1.28
2D	Brass	1/2	1.40	1.35	1.25	1.44	1.53

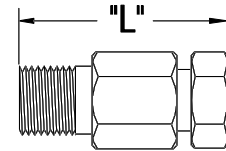

Re-Adjustable*			Available Sizes and "L" Length				
Code	Description	NPT	1/16"	1/8"	3/16"	1/4"	3/8"
3A	Stainless Steel	1/8	1.21	1.21	1.21	N/A	N/A
3B	Stainless Steel	1/4	N/A	1.40	1.43	2.50	2.50
3D	Stainless Steel	1/2	N/A	1.66	N/A	1.76	1.82

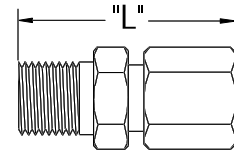

NOTE: All Re-adjustable fittings contain Teflon ferrules standard  
 Consult Sales for Neoprene or Lava ferrules

## Mounting Flanges\*

Code	Description
25	Flange w/ Brass Compression, Adjustable
26	Flange w/SS Compression, Adjustable

\* NOT AVAILABLE WITH TEFLON COATED SHEATH!

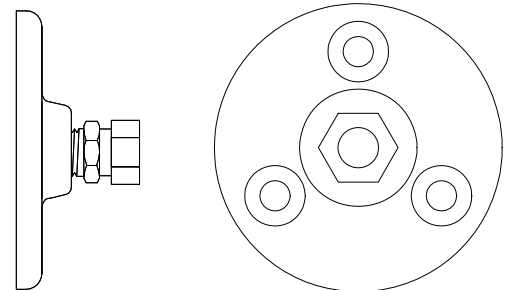

## Double Ended Hex Nipples

Code	Description	NPT	"L"	Compatible with Head Order Codes
45	Steel, brazed on	1/2	2.10	T, V, W, 1, 2, 3, 4, 5, 8
46	Stainless Steel (316SS)	1/8	1.01	T, V, X, Y, 1
47	Stainless Steel (316SS)	1/4	2.10	T, V, X, Y, 1
48	Stainless Steel (316SS)	1/2	2.10	T, V, W, 1, 2, 3, 4, 5, 8
55	Steel, spring loaded	1/2	2.10	T, V, 1, 2, 3, 4, 5, 8
56	Stainless Steel, spring loaded	1/2	2.10	T, V, 1, 2, 3, 4, 5, 8
57	Stainless Steel, self contained spring loaded (1/4" sheath only)	1/2	2.50	T, V, W, 1, 2, 3, 4, 5, 8
60	Stainless Steel (316SS)	3/4	2.50	T, V, W, 1, 2, 3, 4, 5, 8
61	Stainless Steel (316SS)	1	2.50	T, V, W, 1, 2, 3, 4, 5, 8

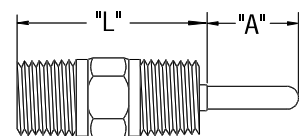

# SHEATH MOUNTING FITTINGS and BEND OPTIONS

## Bayonet Fittings

Code	Description	Available Sheath Sizes
27	Adjustable Bayonet Fitting	1/8
28	Re-Adjustable Bayonet Fitting	1/8
29*	Fixed Bayonet Fitting	1/8 3/16 1/4

\* Insert "U" length  
Ex. 2904 = 4" "U" length

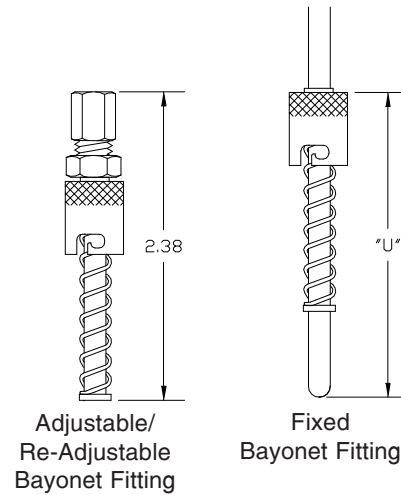

## Weld Pads

Code	Description
35	Perpendicular Pad, 316 SS, 1" x 1"
36	Horizontal Pad, 316 SS, 1" x 1"
37	Perpendicular Radius Pad*, 316 SS, 1" x 1"
38	Horizontal Radius Pad*, 316 SS, 1" x 1"

\*Specify Radius (Ex. 37(2)=2"R) & consult sales for availability

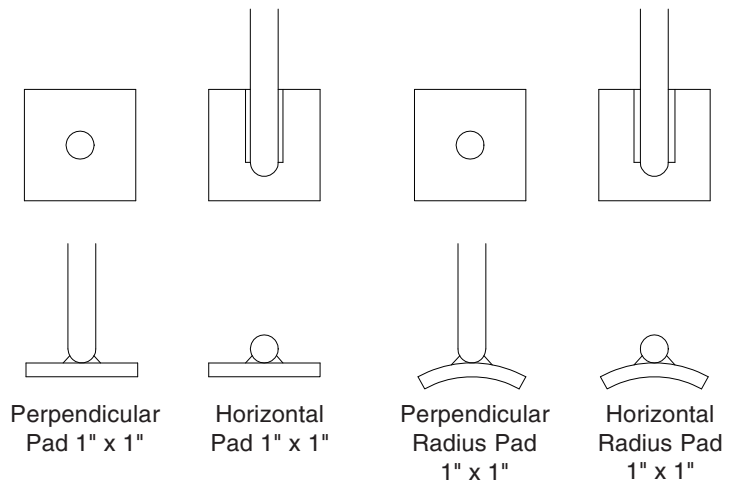

## Sheath Bends

Code	Description
A*	90° Bend
B*	45° Bend

\* Insert "U" Length  
Ex. A04=4" "U" Length

